

## Fork-type cable lug - C-FCI 2,5/M6 - 3240041

Please be informed that the data shown in this PDF Document is generated from our Online Catalog. Please find the complete data in the user's documentation. Our General Terms of Use for Downloads are valid (<http://phoenixcontact.com/download>)



Fork-type cable lug, blue, 1.52.5 mm<sup>2</sup>, M6

### Your advantages

- ✓ The fork-type cable lugs without plastic sleeve feature a hard-soldered neck. In conjunction with the CRIMPFOX-RC ... and CRIMPFOX-RCI ... pliers they can be used to achieve maximum conductor pull-out forces
- ✓ The insulated versions are halogen-free and feature "EASY ENTRY" technology



### Key Commercial Data

Packing unit	1 pc
Minimum order quantity	50 pc
GTIN	 4 046356 452588
GTIN	4046356452588
Weight per Piece (excluding packing)	1.010 g
Custom tariff number	85369010
Country of origin	China

### Technical data

#### Dimensions

Length (b)	22.5 mm
Width (a)	10.7 mm
Maximum stripping length	8 mm
Length of insulation sleeve (c)	11 mm
Inner dimension of the insulating collar (d)	4.5 mm
Distance between the center and the insulation sleeve (e)	7.6 mm

# Fork-type cable lug - C-FCI 2,5/M6 - 3240041

## Technical data

### Dimensions

Inner diameter (f)	6.5 mm
Material thickness (g)	0.8 mm

### General

Color	blue
Stripping length	8 mm
Components	halogen-free
Material	Copper
Insulating material	PA
Coating	tin-plated

### Standards and Regulations

Flammability rating according to UL 94	V2
--	----

### Environmental Product Compliance

China RoHS	Environmentally friendly use period: unlimited = EFUP-e
	No hazardous substances above threshold values

## Drawings

Dimensional drawing

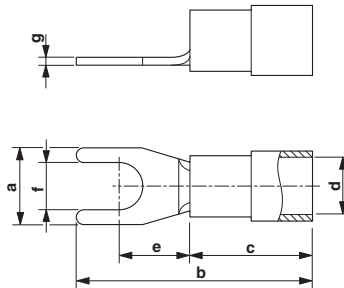

## Classifications

### eCl@ss

eCl@ss 10.0.1	27400204
eCl@ss 11.0	27400204
eCl@ss 4.0	27060700
eCl@ss 4.1	27060700
eCl@ss 5.0	27400200
eCl@ss 5.1	27400200
eCl@ss 6.0	27400200

## Fork-type cable lug - C-FCI 2,5/M6 - 3240041

### Classifications

#### eCl@ss

eCl@ss 7.0	27400204
eCl@ss 9.0	27400204

#### ETIM

ETIM 2.0	EC000005
ETIM 3.0	EC000005
ETIM 4.0	EC001052
ETIM 6.0	EC001052
ETIM 7.0	EC001052

#### UNSPSC

UNSPSC 6.01	27113201
UNSPSC 7.0901	27121703
UNSPSC 11	27121703
UNSPSC 12.01	27121703
UNSPSC 13.2	27121707
UNSPSC 18.0	27121707
UNSPSC 19.0	27121707
UNSPSC 20.0	27121707
UNSPSC 21.0	27121707